

OFFICE/FLEX

SUITE 280

1933 Davis Street

SUITE SPECS

- 1,512 sq. ft.
- Plug & Play ready
- 6ft Chemical fume hood
- 2-comp lab sink and safety shower
- **LOWEST LAB/R&D RENTS IN THE MARKET**
- Scalable campus for growth companies
- Flexible lease terms
- 25 ft clear Height
- 2 drop ceiling offices
- 125 AMps at 110/208v 3-phase

KEY

- ==== Unit walls (height varies)
- - - Imaginary line

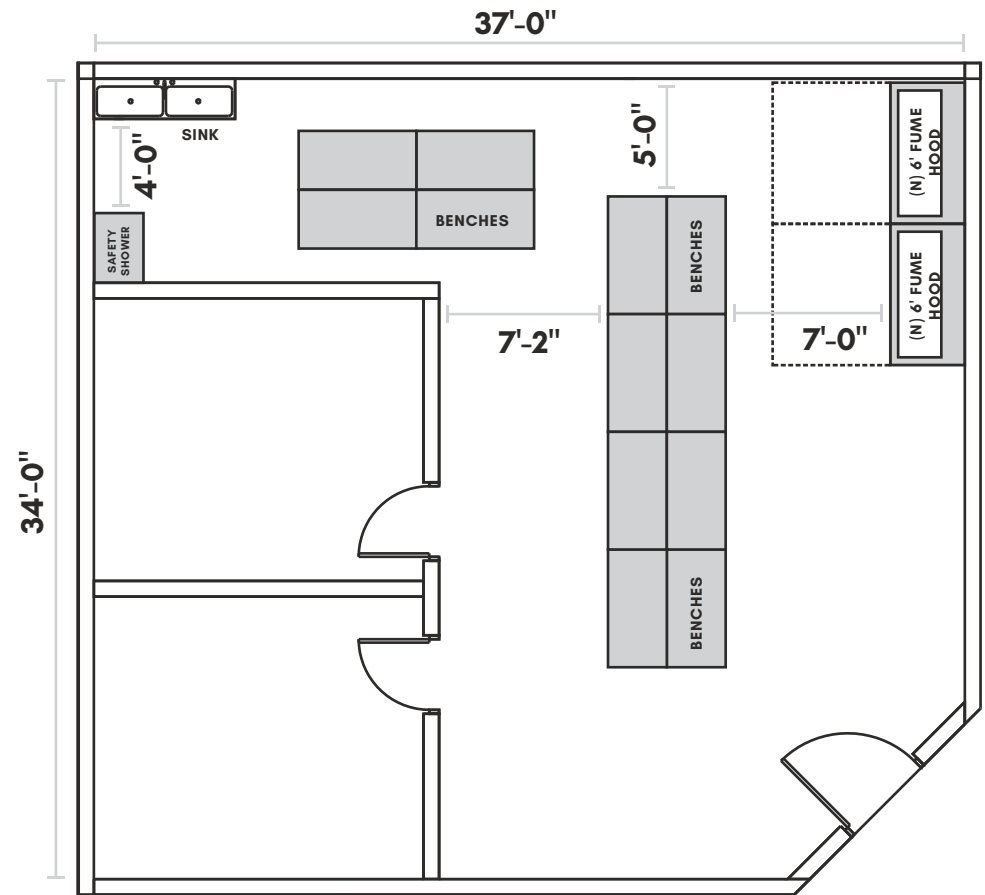

GATE 510

GROW YOUR BUSINESS HERE

510 430-0133 | 1933 Davis Street | San Leandro, CA 94577 | GATE510.COM